

NOMAD system

IMPORTANT: Follow instructions carefully! Save instructions for future reference.
Printable instructions available online at: www.mioculture.com/pdf/nomad.pdf

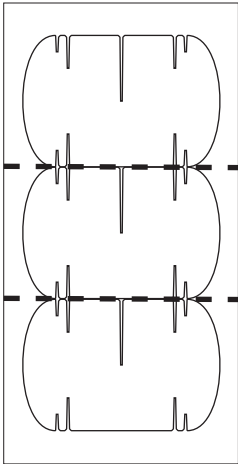

STEP 1 Separate components by bending back and forth and snapping them at score lines.

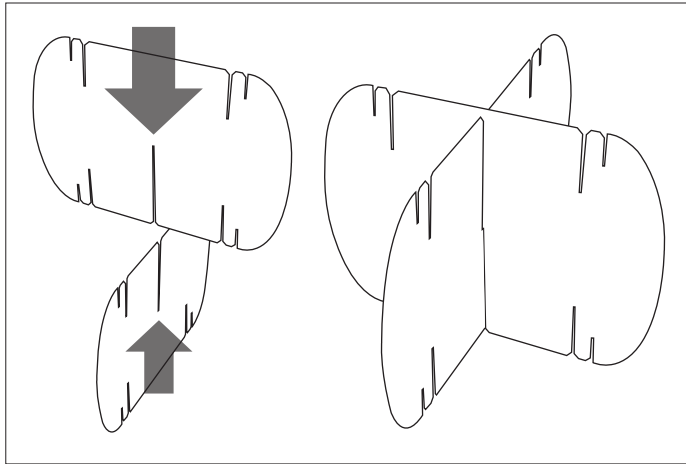

STEP 2 Connect components by inserting one into another along the central slot.

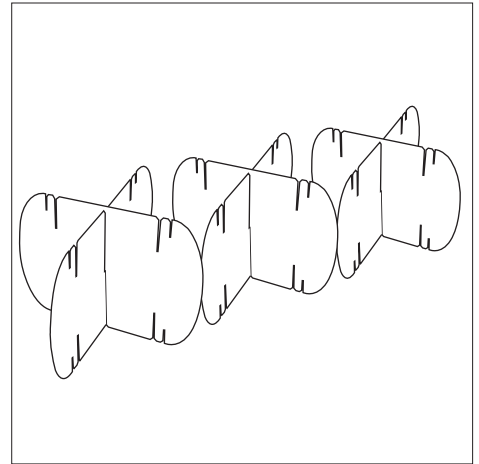

STEP 3 Arrange constructed modules one next to the other in the location chosen for the wall. The first row should be a minimum of three modules long for greater stability.

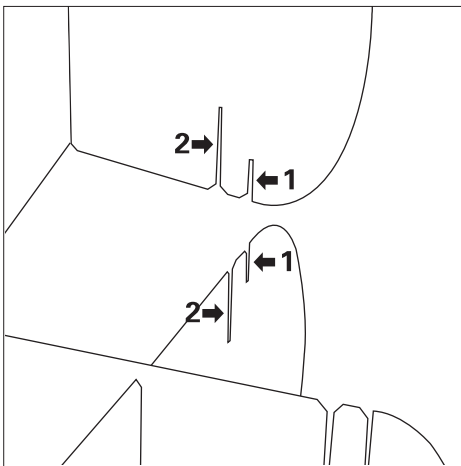

Step 4 Subsequent rows of modules will connect to the modules on the row below using the slots on the sides. Select slot 1 to build an open configuration or slot 2 to build a closed configuration.

1- OPEN CONFIGURATION

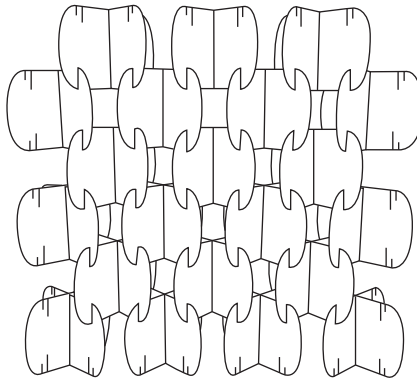

2- CLOSED CONFIGURATION

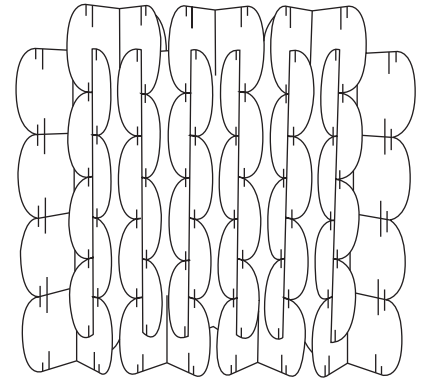

IMPORTANT: Use the selected slot in all subsequent rows and throughout the wall arrangement.

Additional Information

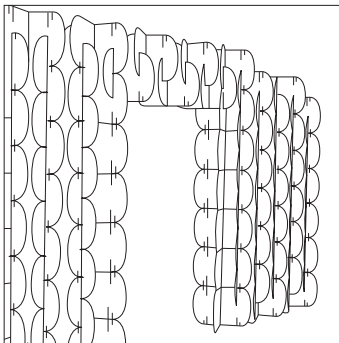

Recycling

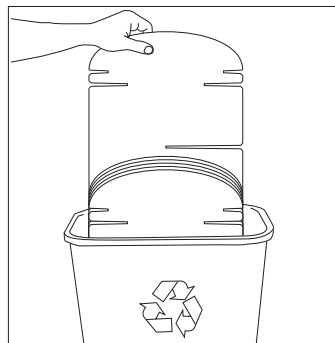
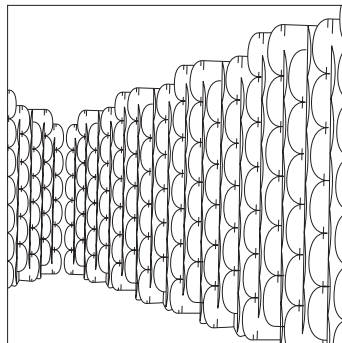

Nomad is made from 100% kraft cardboard. This product can be recycled in most curbside recycling and office recycling programs. Thank you for recycling!

Additional instructions, including doorway and corner construction, are available for download at: www.mioculture.com/pdf/nomadbuild.pdf (coming soon)