

TRASK Connecting Tracks

IMPORTANT: Follow instructions carefully! Save instructions for future reference.
Printable instructions available online at: www.mioculture.com/pdf/traskconnectingtracks.pdf

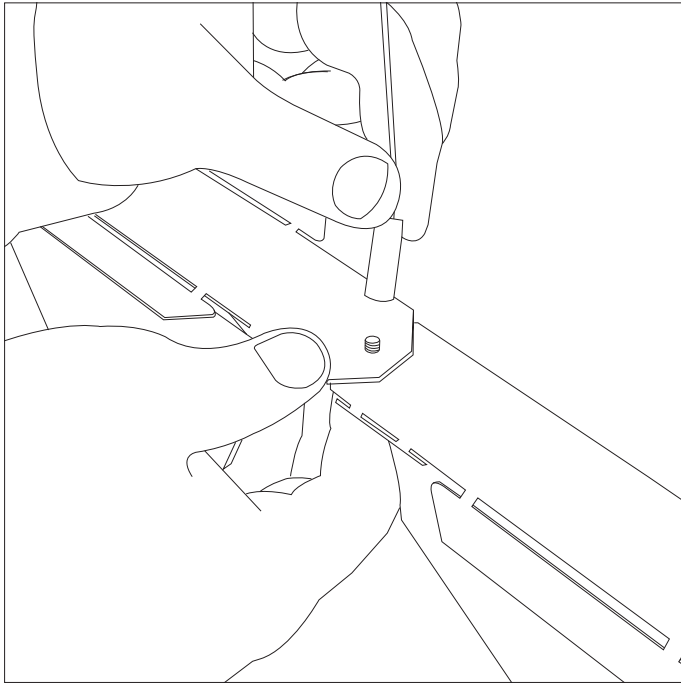

STEP 1 Overlap the ends of the Trask lamps and align the holes. Insert the screw that attaches to the suspension cable from the bottom through both lamps. Once the screw is in place, thread in the suspension hardware by hand and then from the bottom with a screw driver so that both lamps are secured together by the hardware.

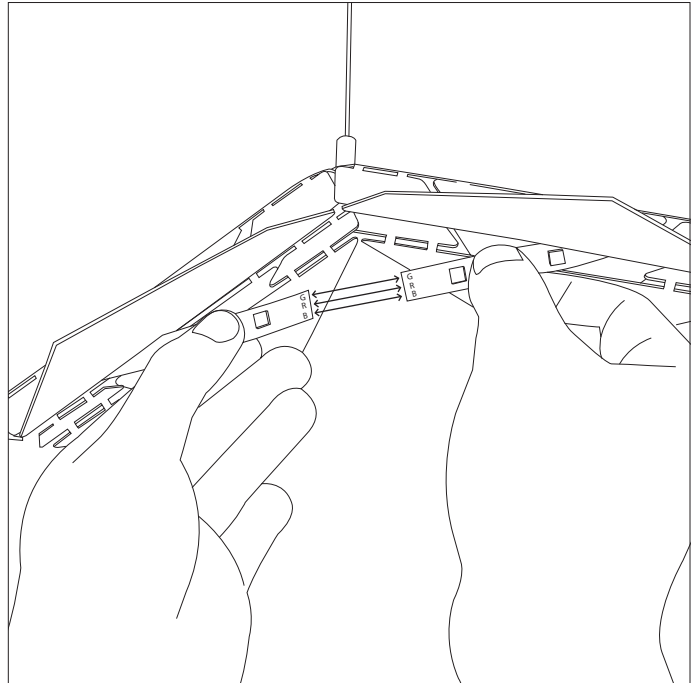

STEP 2 Check that the R-G-B letters marked at the ends of both LED light strips line up as shown above. **IMPORTANT:** The letters must be aligned in order for the lamp to work. If the letters do not align you must remove the LED strip and re-install so that the LED strips are in alignment.

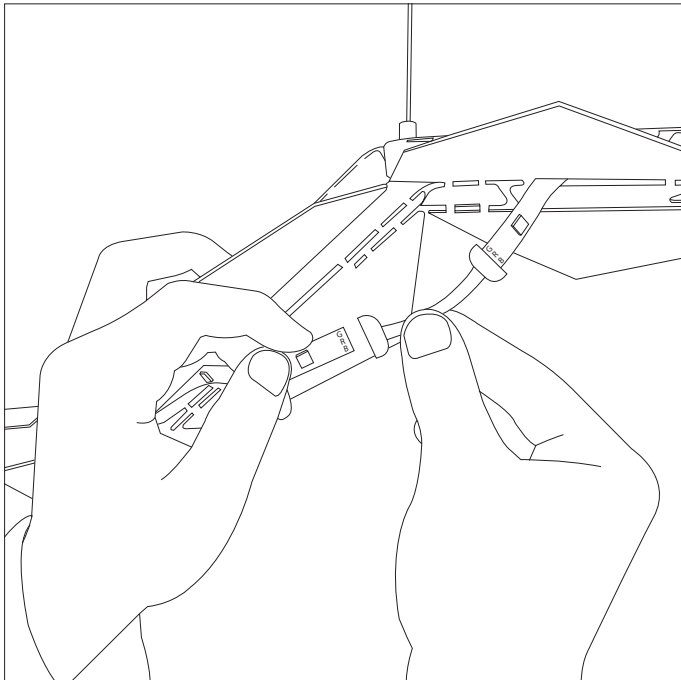

STEP 5 Connect the LED track connector to the ends of both LED strips. Make sure the connection is solid and test the lamp by turning it on.

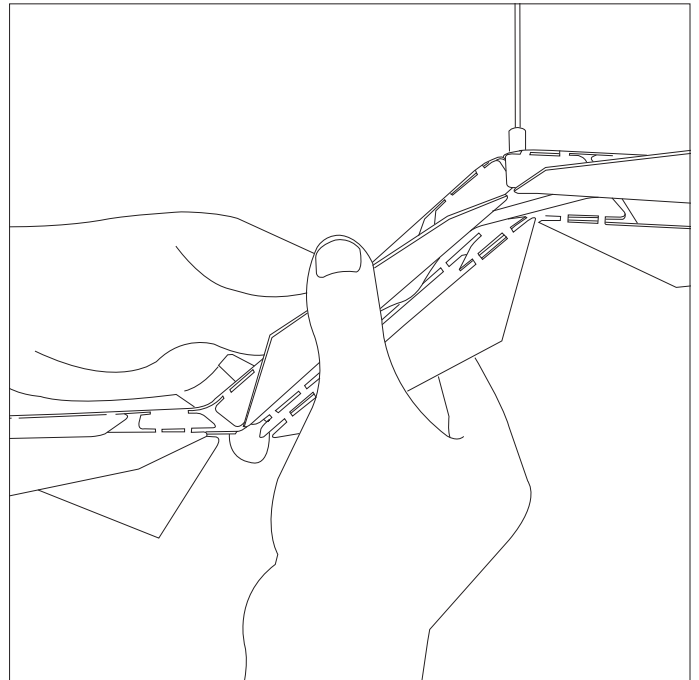

STEP 4 Squeeze the Trask leaflets closed so that they cover and secure the LED strips and connector.