

Parts List

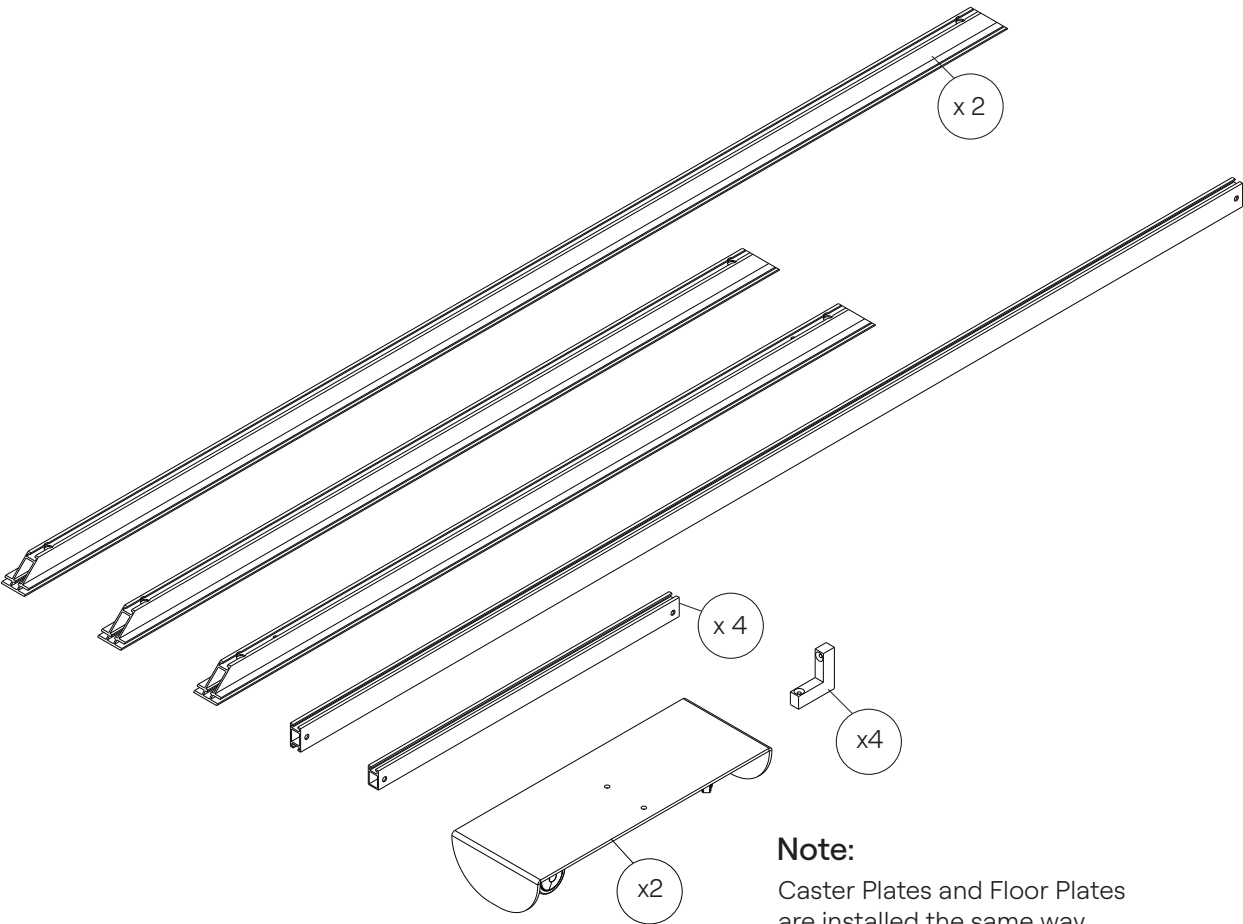

**Note:**  
Caster Plates and Floor Plates  
are installed the same way.

Hardware

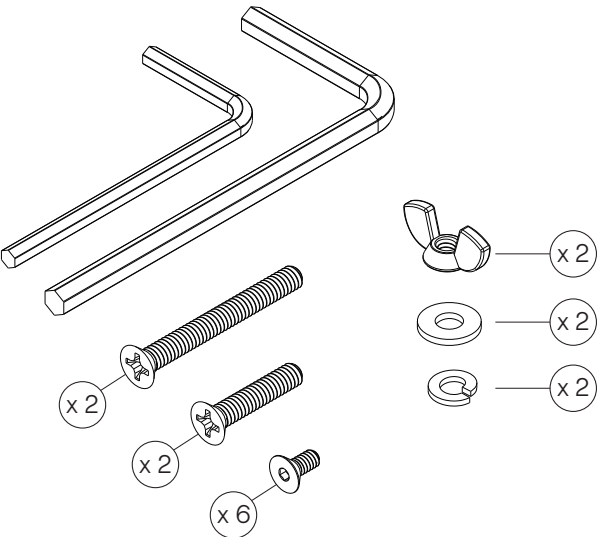

Acoustic Board & Textile Cover

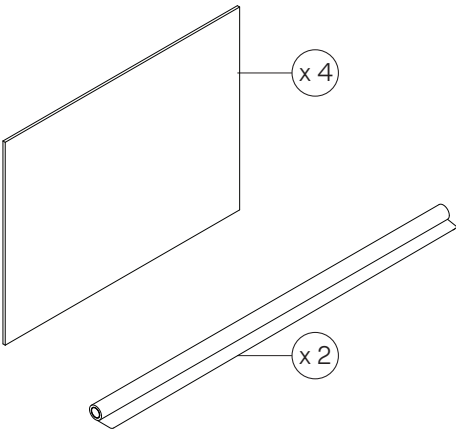

### Step 1

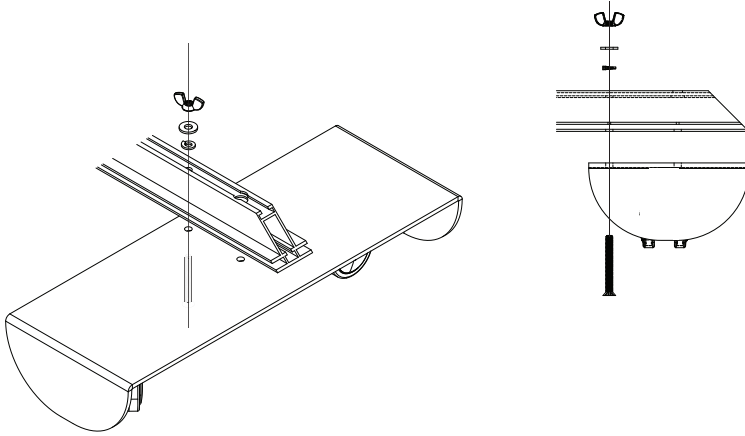

Align and secure the short extrusion with four holes at the bottom to the caster base using the long screw, wingnut and washers.

### Step 2

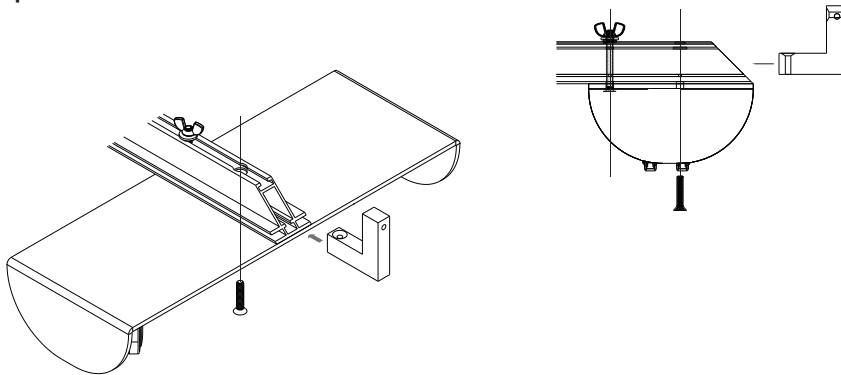

Use the shorter screw to secure the caster base into the threads in the frame.

### Step 3

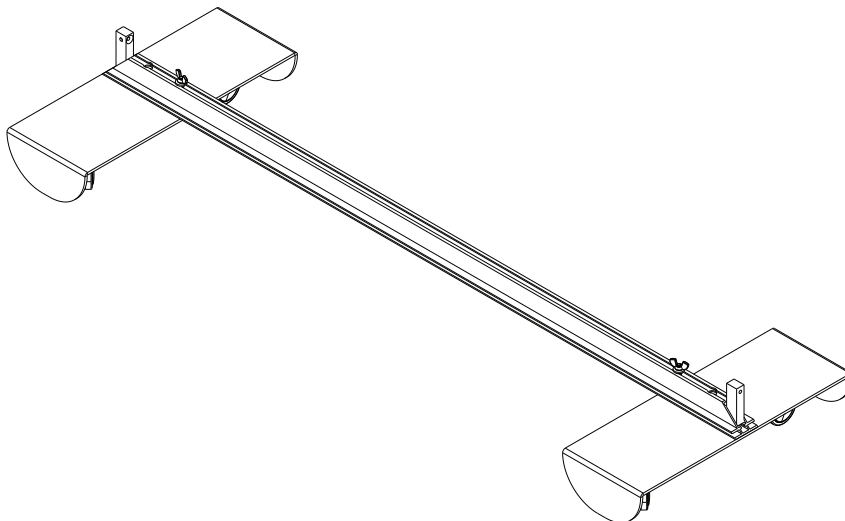

Repeat step 2 so that the bases are securely attached.

### Step 4

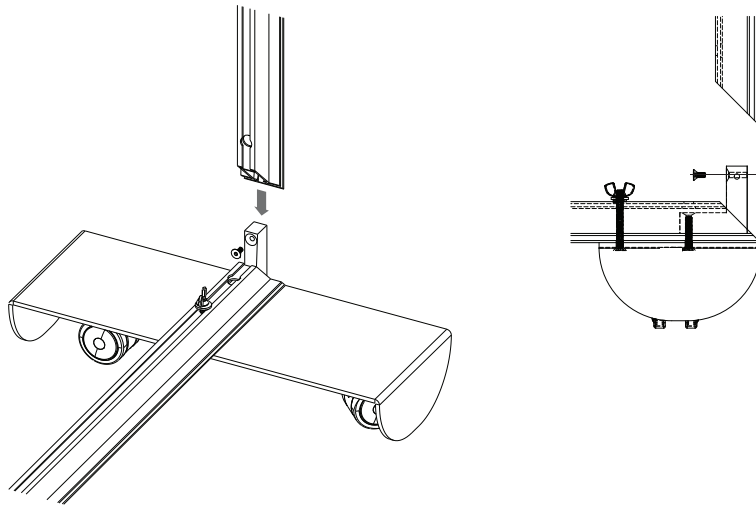

Insert the long vertical extrusion and secure with the hex screw and allen key. Repeat this step on the other side.

### Step 5

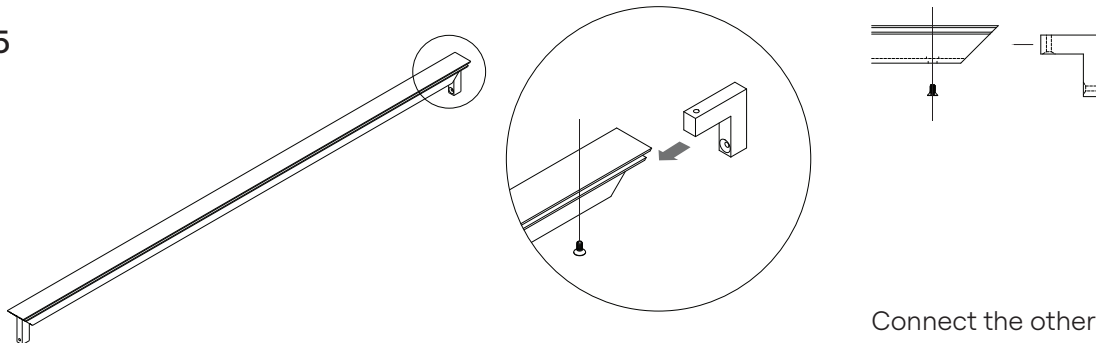

Connect the other set of L brackets by sliding them inside the second short extrusion. Secure with hex screws.

### Step 6

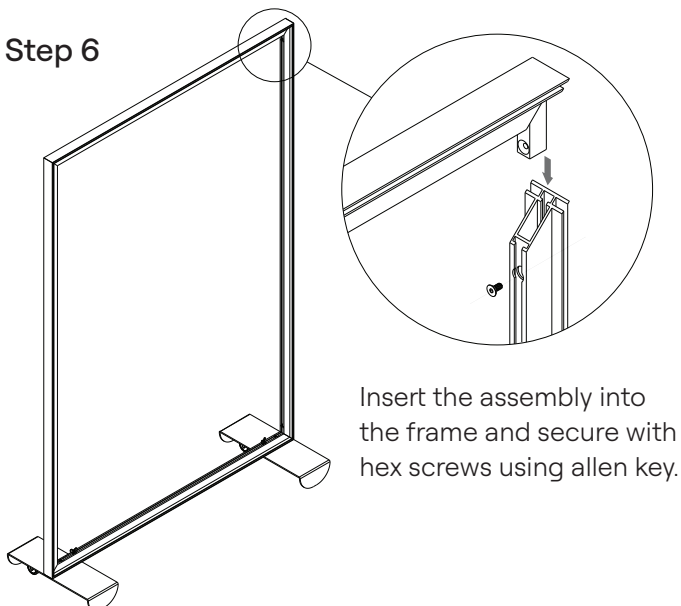

Insert the assembly into the frame and secure with hex screws using allen key.

### Step 7

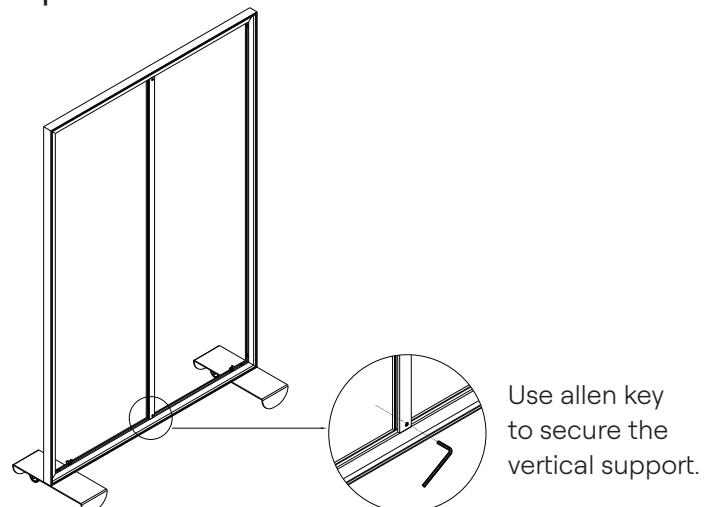

Use allen key to secure the vertical support.

### Step 8

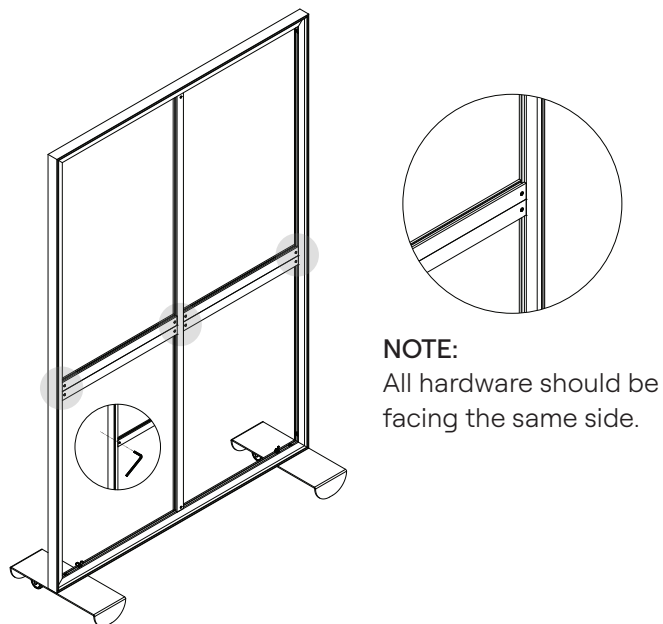

Install the short cross bars centered on frame. Connect them as shown to the central vertical support. Install one cross bar on top of the other as shown.

### Step 9

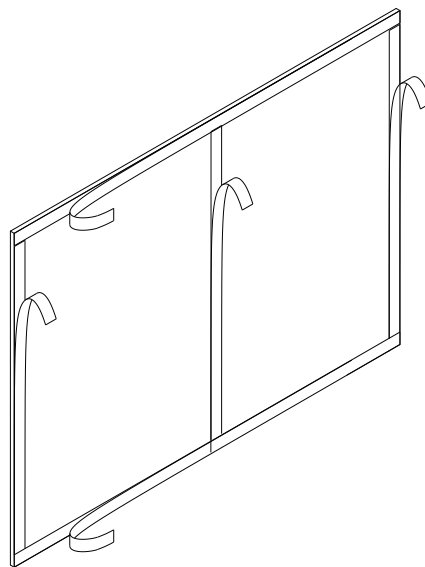

Apply included adhesive tape to acoustic boards perimeter. **Press tape firmly and repeatedly** to ensure adhesion.

### Step 10

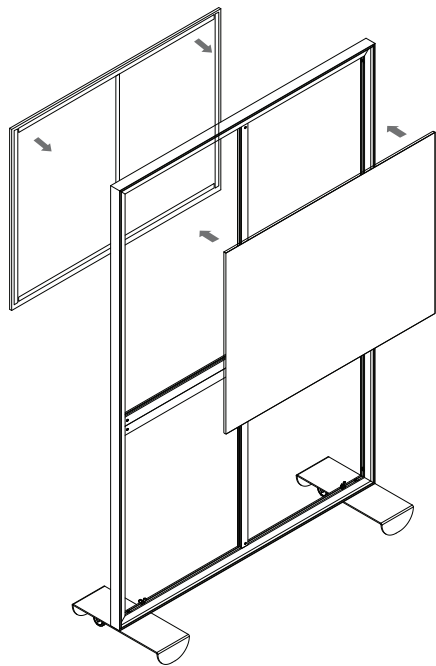

Remove tape liner and secure acoustic boards to frame. **Press firmly to frame.**

### Step 11

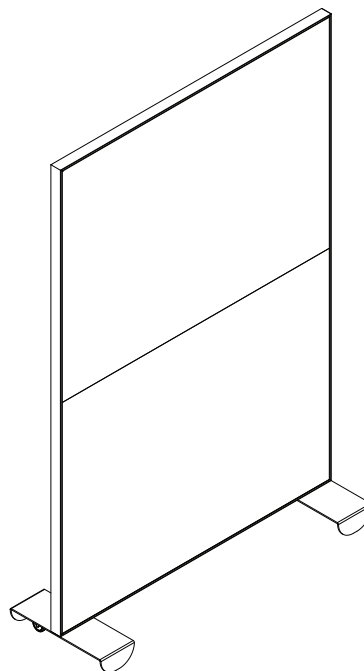

Repeat step 10 so the frame is completely sealed with the acoustic boards.

## Step 12

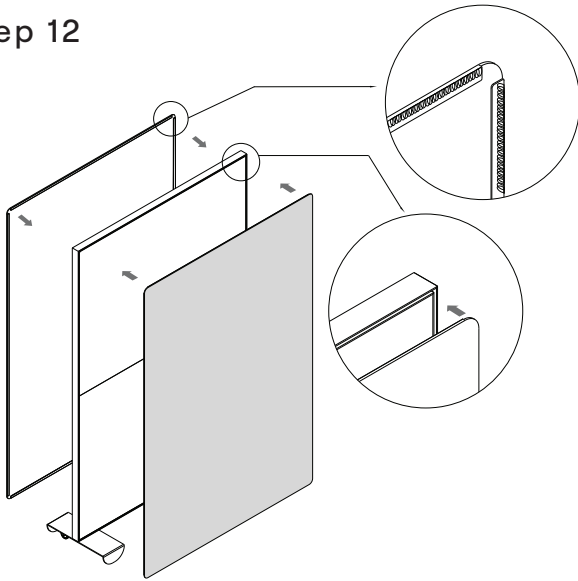

Install textile skins by guiding the silicone bead into the frame channel. Follow Steps 13 - 15 carefully for best results.

## Step 13

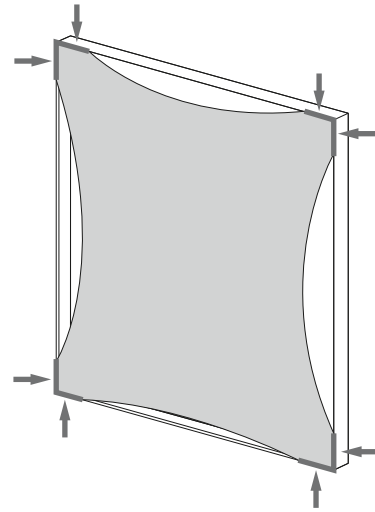

Always begin with the corners. Start by Inserting the upper left corner of the skin and work your way around clockwise.

## Step 14

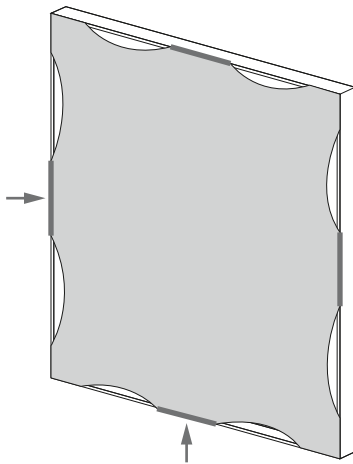

Pull and insert the center of the skin along the top edge and insert into the channel. Repeat along each side, always pulling the center of the skin into the channel.

## Step 12

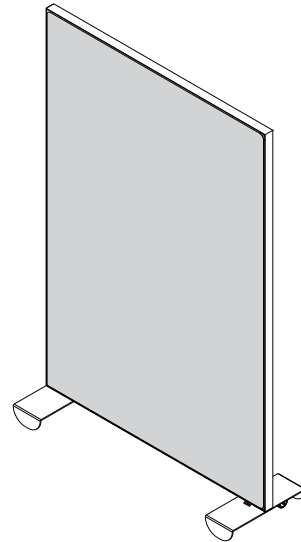

Complete installation by inserting all the edges into the channel. Start at the center and work your way towards the corner on each side.

For questions or support  
give us a ring—we're here to help!

[WWW.MIOCULTURE.COM](http://WWW.MIOCULTURE.COM)



Email: [info@mioculture.com](mailto:info@mioculture.com)  
US Toll Free: 1-888-563-3916  
International: +1 (215) 925-9359

All trademarks, service marks and trade names (MIO Culture, product names and the MIO Culture logo) are owned and registered by MIO. All content including but not limited to text, designs, graphics, photos and all other content ("Content") is a collective work under the United States and other copyright laws and is the proprietary property of MIO Culture. All rights reserved. ©2025 MIOIM LLC.