

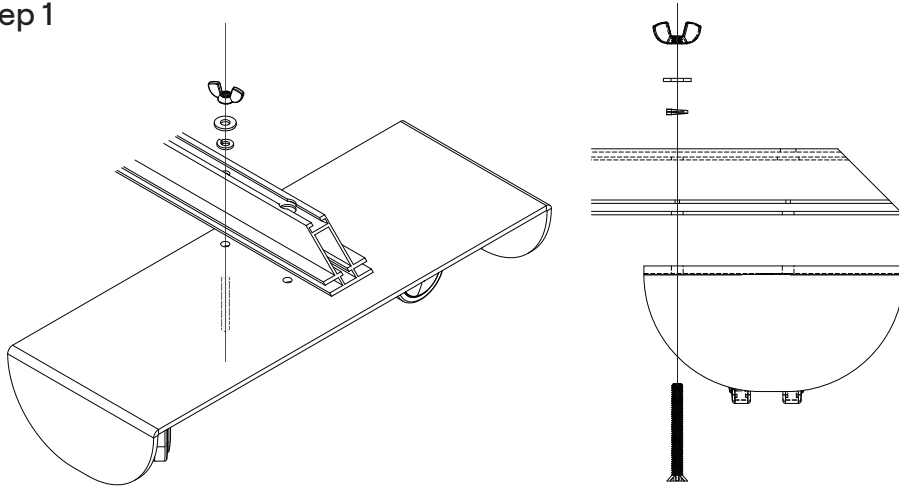

Step 1



Align and secure the short extrusion with four holes at the bottom to the caster base using the long screw, wingnut and washers.

Step 2

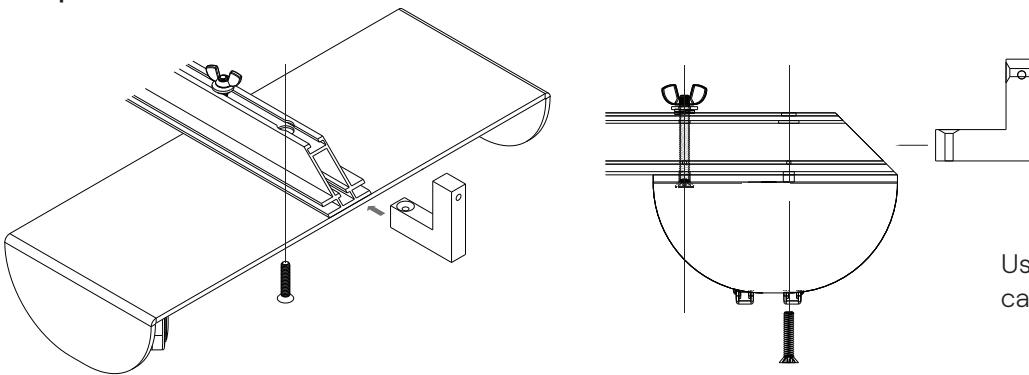

Use the shorter screw to secure the caster base into the threads in the frame.

Step 3

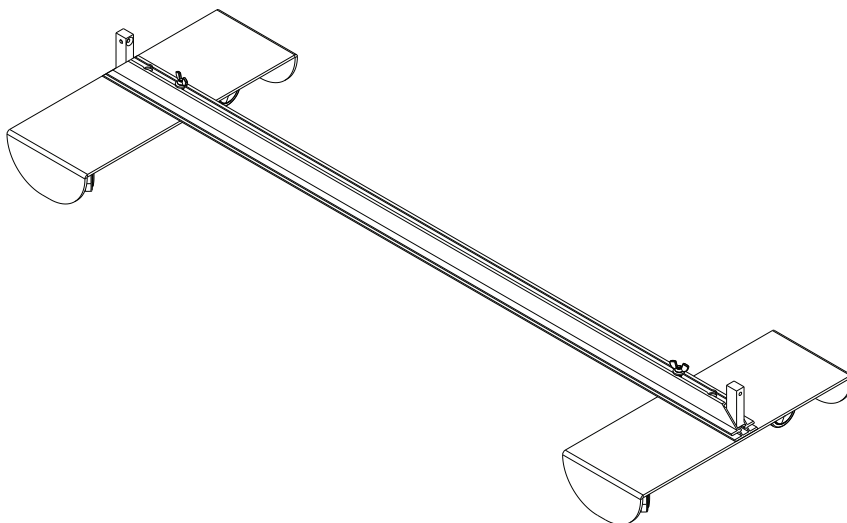

Repeat step 2 so that the bases are securely attached.

Step 4

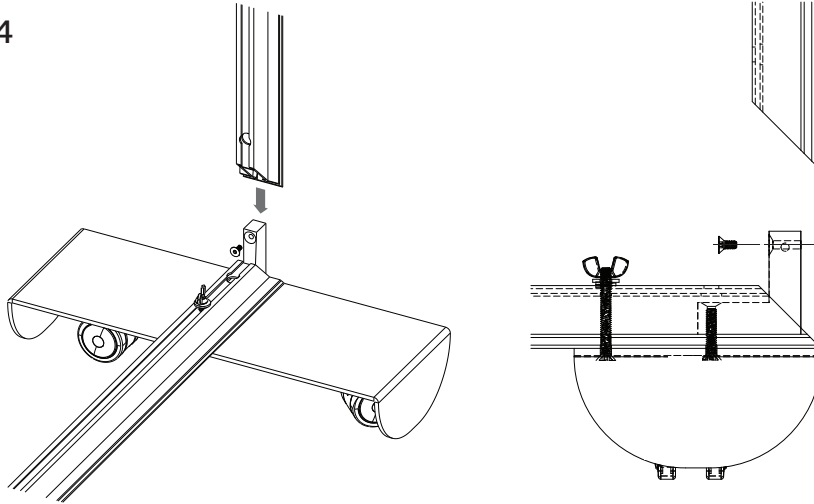

Insert the long vertical extrusion and secure with the hex screw and allen key. Repeat this step on the other side.

Step 5

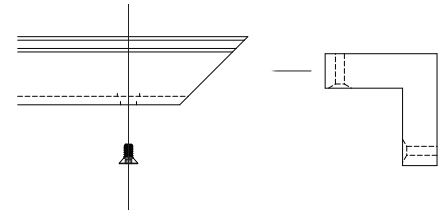
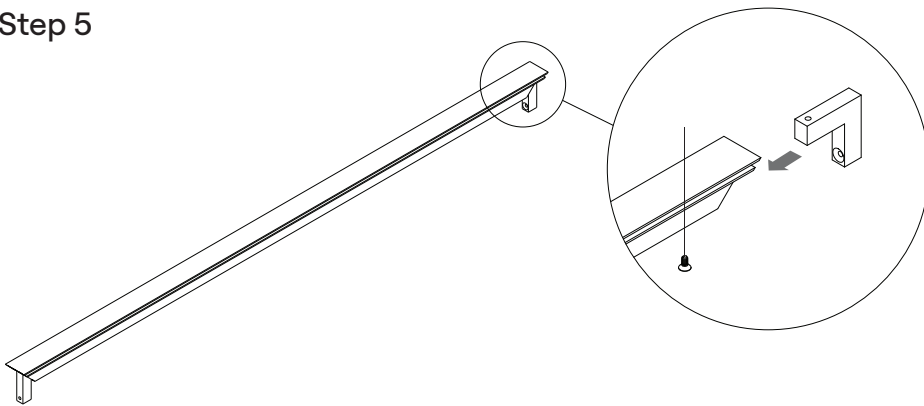

Connect the other set of L brackets by sliding them inside the second short extrusion. Secure with hex screws.

Step 6

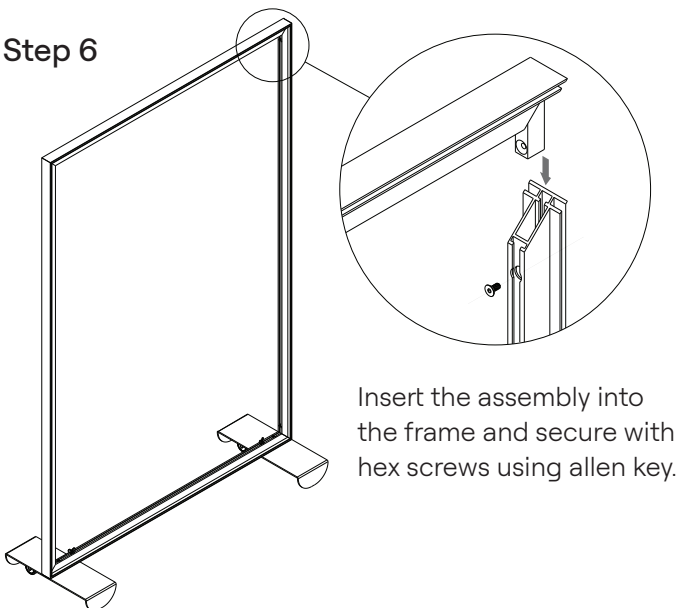

Insert the assembly into the frame and secure with hex screws using allen key.

NOTE

Shift Wall assemblies with FeltForms Tiles continue on the next page. Assemblies with tackable surfaces and textiles continue on last page.

Step 7

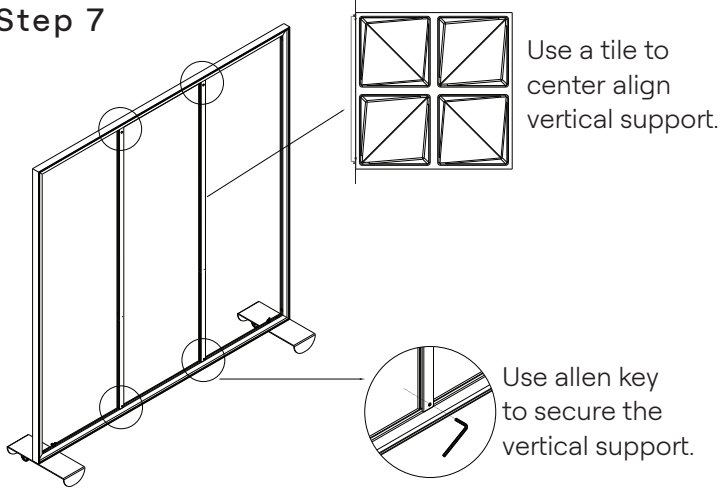

Step 8

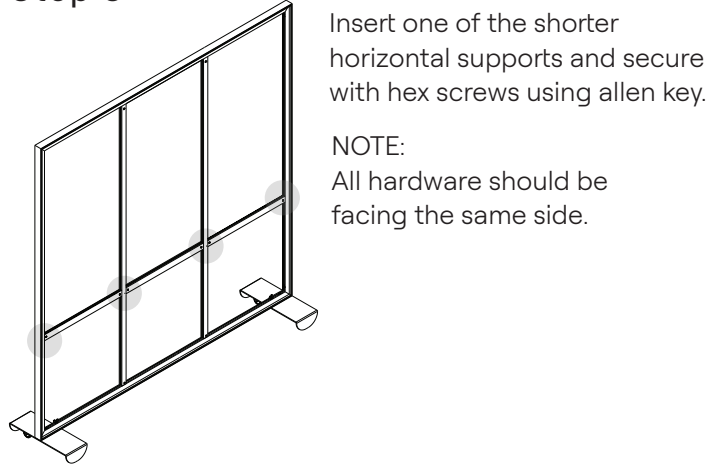

Step 9

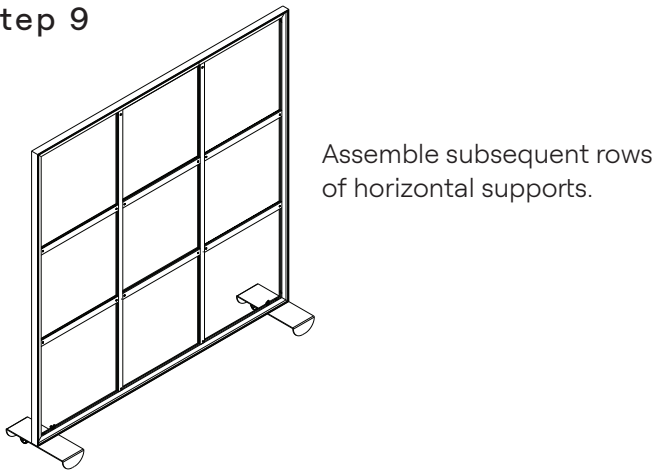

Step 10

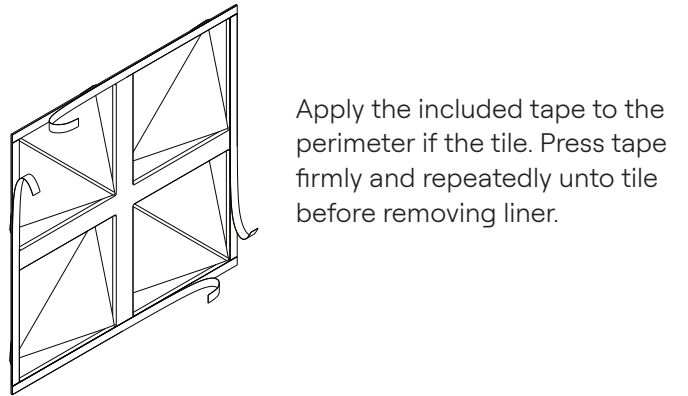

Step 11

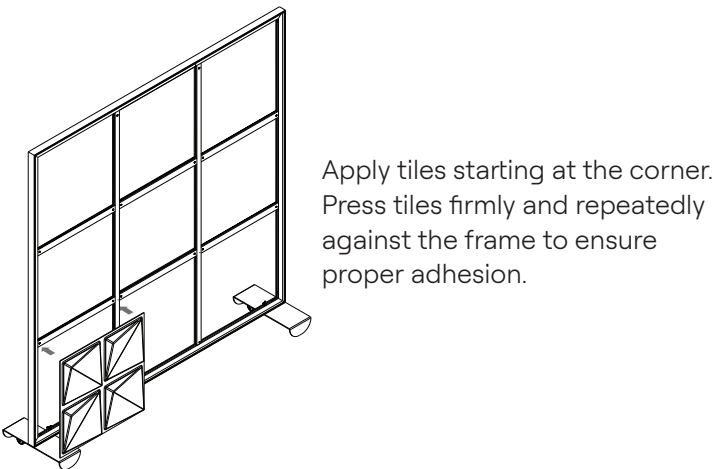

Step 12

