

**CONTENTS +  
SURFACE PREP**

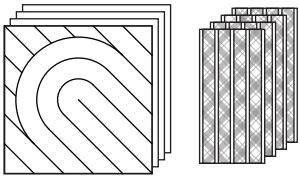

4 ACOUSTIC TILES 16 ADHESIVE STRIPS

Prepare the installation surface by cleaning it thoroughly.

2

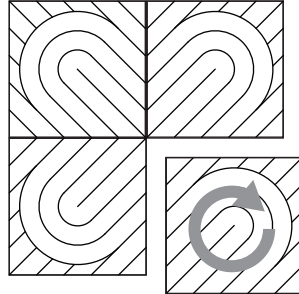

Select a pattern for installation. Arrange it on the floor by rotating the tiles to preview.

3

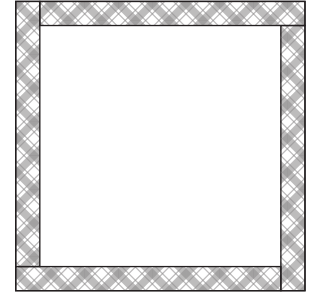

Peel adhesive strips from sheet and apply them as shown so that each corner is covered.

**TEMPORARY  
INSTALLATION**

4

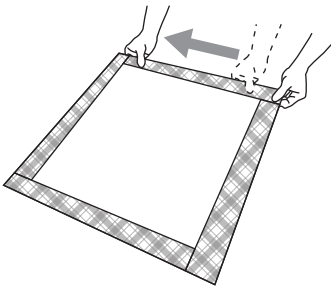

Press firmly along each strip **repeatedly** to ensure the adhesive strips are secure.

5

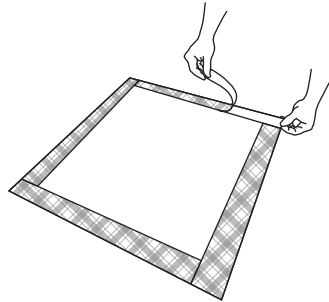

Peel backing off of each strip.

**PERMANENT  
INSTALLATION**

6

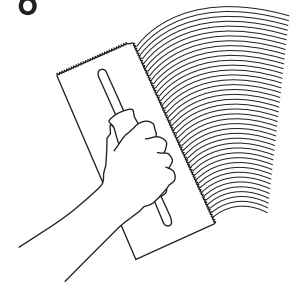

Trowel tile mastic (Type 1 Tile Adhesive or Titebond GREEN Choice Fast Grab FRP Adhesive) on wall, apply a thin coat to back of tiles as well. For smooth walls use a 3/16" V-notched trowel Rough walls use a 5/16" V-notched trowel for application.

7

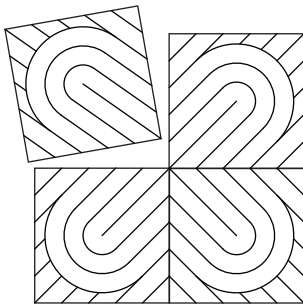

Use a straight edge and level to align tiles. Center design start applying tiles from the most visible edge to the least visible.

8

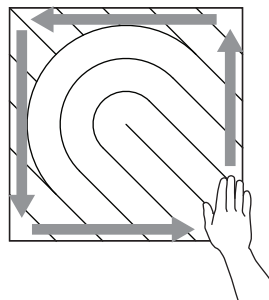

Once tiles are applied to wall, press firmly along each edge **repeatedly** until the tile is securely adhered. For permanent installation, clean off excess mastic.

MIOCULTURE.COM



All trademarks, service marks and trade names (MIO, product names and the MIO logo) are owned and registered by MIO. All content including but not limited to text, designs, graphics, photos and all other content ("Content") is a collective work under the United States and other copyright laws and is the proprietary property of MIO. All rights reserved. ©2019 MIOIM LLC